

APEC

SEKIZLI

APEC

M O D U L A R

MODULAR STRUCTURES

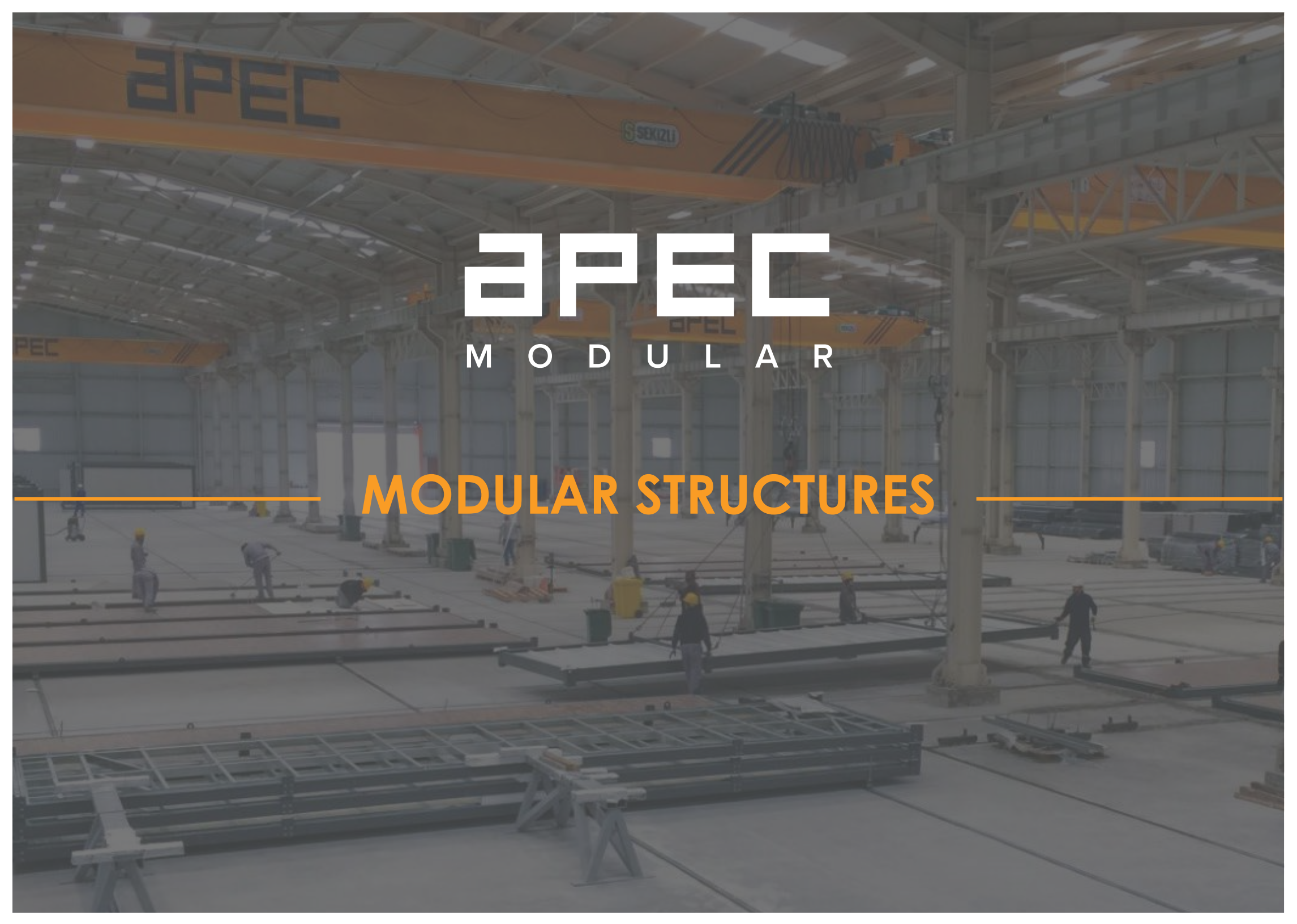

Company Overview

ABOUT US

- Established: 2007
- Employees: 68
- Office: İstanbul
- Factory: Yalova

PRODUCT CATALOGUE

- Industrial and Commercial Buildings
- Residential Buildings
- **Modular Buildings**
- Tiny House

SERVICES

- Engineering Consulting
- Structural Steel Production
- Project Execution
- General Contractor



Our Technology

HIGH-GRADE STEEL

- S350, S390, S450, S550
- Hot-dip galvanized zinc coating (275g/m²)

SUPERIOR ENGINEERING

- R&D department offers advanced solutions to various needs
- Local climate, ground and seismic conditions are taken into account
- Design conforms to National Regulations and International Standards
- State of the art engineering, design and production software

CUTTING-EDGE MANUFACTURING TECHNIQUES

- CE certified production process
- Super fast production with automated lines
- CNC manufacturing lines eliminate human error
- Laser imprinted codes ensure smart packaging and assembly

LOW FREIGHT COSTS AND QUICK ASSEMBLY

- High-strength bolted system
- Easy and fast assembly process with simple labor and light machinery
- Demounted and lightweight system enables even long-distance freight to be cost-efficient

VARIOUS CLADDING OPTIONS

- Sandwich panels with different insulation and color options
- Single skin cladding with different forms and colors
- For residential projects, it is possible to use materials and finishings for all different quality segments



Advantages of Cold-Formed Steel Structures

- **Lighter** and **stronger** due to high strength-to-weight ratio
- **Earthquake resistance** due to lightness and ductility
- **Fast** and **precise** production with high level of quality control
- Simple, quick and **accurate assembly**
- **Reduced foundation requirements and freight costs** due to lightweight superstructure
- **Reduced labor costs** as pre-engineered systems do not require highly-skilled on-site labor
- **Reduced site costs** since heavy machinery is not required and assembly duration is shorter
- **Low-maintenance**, galvanized members do not require sand-blasting or painting
- Excellent performance characteristics with regards to **acoustic** and **thermal insulation**
- **Sustainable construction** with reduced carbon footprint
- 100% recyclable and **no material wastage**, reducing the overall environmental impact
- **Dry production** and site without the use of limited water resources
- **Quicker reach to the operational life** of the building due to the speed of construction
- **Demountable** with negligible loss, extendable or relocatable
- Offers **greater ROI** on overall investment due to the aforementioned benefits



Sakura Park Housing Project - Yalova, Turkey



Coca Cola Bottling Factory - Isparta, Turkey

Modular Structures

APEC Smart Steel Structures distinguishes itself by its cutting-edge and high capacity manufacturing technology and advanced engineering.

APEC engineers and manufactures modular structures made from high quality, galvanized steel in its high-capacity production facilities in Turkey. APEC's engineering is in accordance with DIN norms and Eurocode static calculations.

APEC's modular structures can be swiftly exported to all European countries and the rest of the world in large quantities through flat-pack or monoblock transportation options.



Common Uses for Modular Structures

The versatility of modular structures offers many design options that can be realized in a time efficient way.

- Emergency Housing
- Sanitary Buildings (WC & Shower)
- Construction Site Camps
- Refugee Camps
- Port Offices
- Hangar Offices
- Site Offices
- Educational Buildings
- Medical Buildings
- Remote Sales Offices
- Security Offices



Production Technology and Speed

Our production lines consist of high capacity and fully automated CNC machinery that prevents human error and enables fast production.

APEC's Modular Structures does not require any welding and can be custom configured according to your specifications.

Our production lines include custom and large scale roll-forming lines, press brake, robotic welding machines and various decking and panel manufacturing lines. Our production technology combined with our R&D in engineering makes us an innovator in construction of cold-formed galvanized steel structures.

Apec can manufacture up to 4 x 13 meter size single modular units. The containers can be stacked up up to three levels.



Production Quality

- APEC Modular Structures are produced with cold-formed galvanized steel profiles, which makes them more durable and corrosion resistant in comparison with standard modular containers.
- Electrostatic coating process for steel frames of our modular structures results in superior painting solutions with maximum durability.
- All the materials that go into the production of APEC Modular Containers, such as steel, sandwich panels, flooring, cement board, doors and Windows are CE marked.
- APEC Modular Structures can be designed to be suitable for all climates and it has many cladding, roof, floor insulation options.
- APEC'S Modular Container does not require any welding, it is demountable, modular, and can be custom configured according to your specifications.
- Our modular containers comply with high quality IPS standards and are equipped with a moisture resistant safety switch box.



Office Building



Germany Refugee Camp



Delivery Methods

Monoblock

Container modules are shipped to the field as a block, with the assembly process completely finished.

The number of containers per transport vehicle decreases, the unit transportation cost increases, but on-site labor for finishing the assembly is not required.



Delivery Methods

Flat-Pack

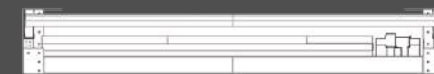
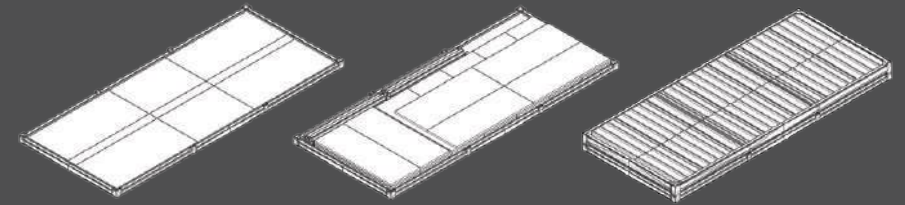

Flat-packed container section

Container modules are partially assembled at the factory, and detailed materials are packaged in folded form for on-site assembly.

The number of containers shipped per transport vehicle increases, the unit transportation cost decreases, but some on-site labor for finishing the assembly is required.

Generally, 12 units of 600 cm x 240 cm containers can be loaded in a flatpack into a truck. One container can be installed by 4 workers in about 1 hour.

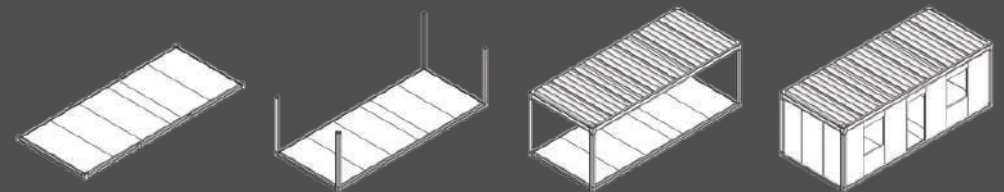

Monoblock Delivery

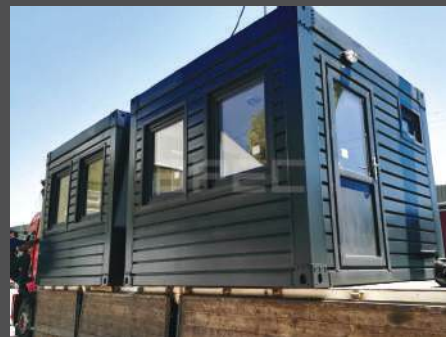

Flat-Pack Delivery



2.4 x 6.0 m Container Models

MODEL - 1

Delivery Method: Monoblock

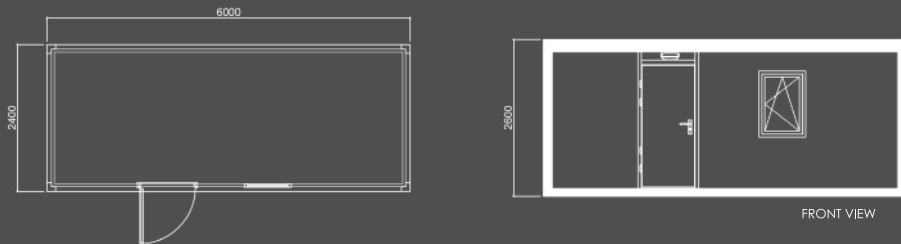

MODEL - 3

Delivery Method: Monoblock

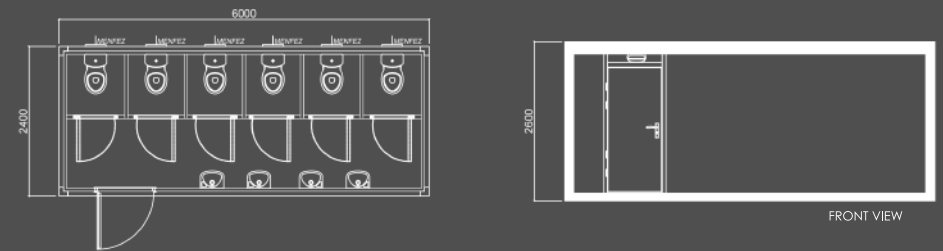

MODEL - 2

Delivery Method: Monoblock

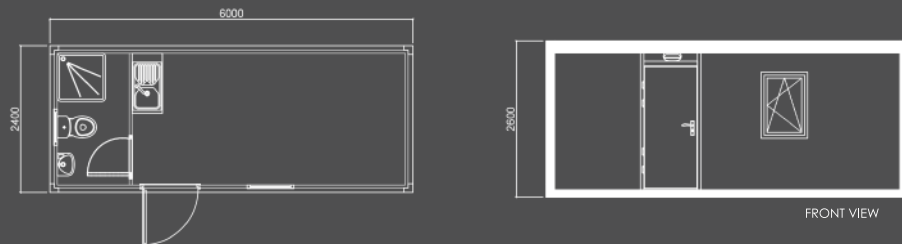

MODEL - 4

Delivery Method: Monoblock

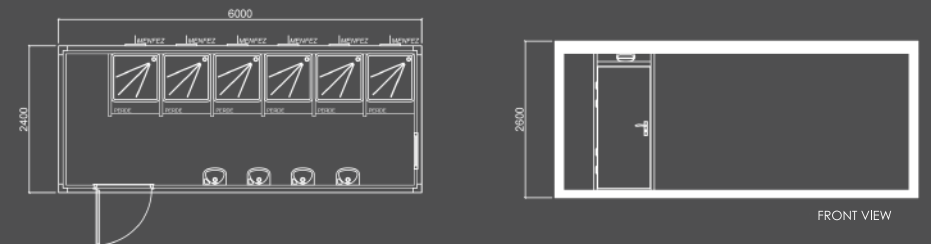

3.0 x 7.0 m Container Models

MODEL - 1

Delivery Method: Monoblock

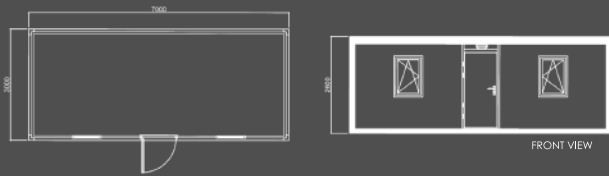

MODEL - 3

Delivery Method: Monoblock

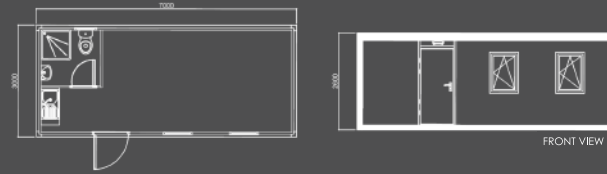

MODEL - 5

Delivery Method: Monoblock

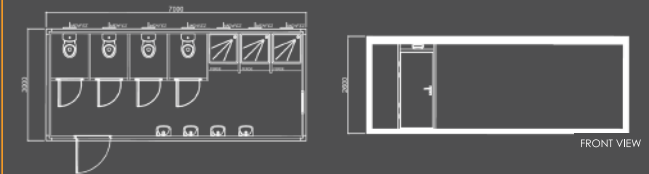

MODEL - 2

Delivery Method: Monoblock

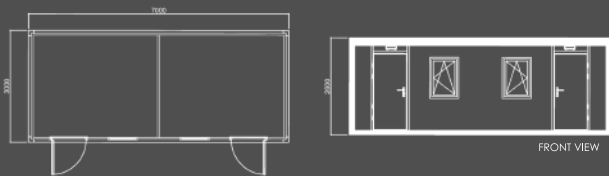

MODEL - 4

Delivery Method: Monoblock

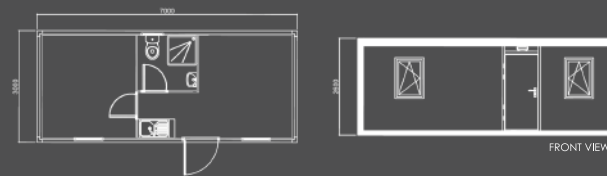

One Storey Modular Container Camp

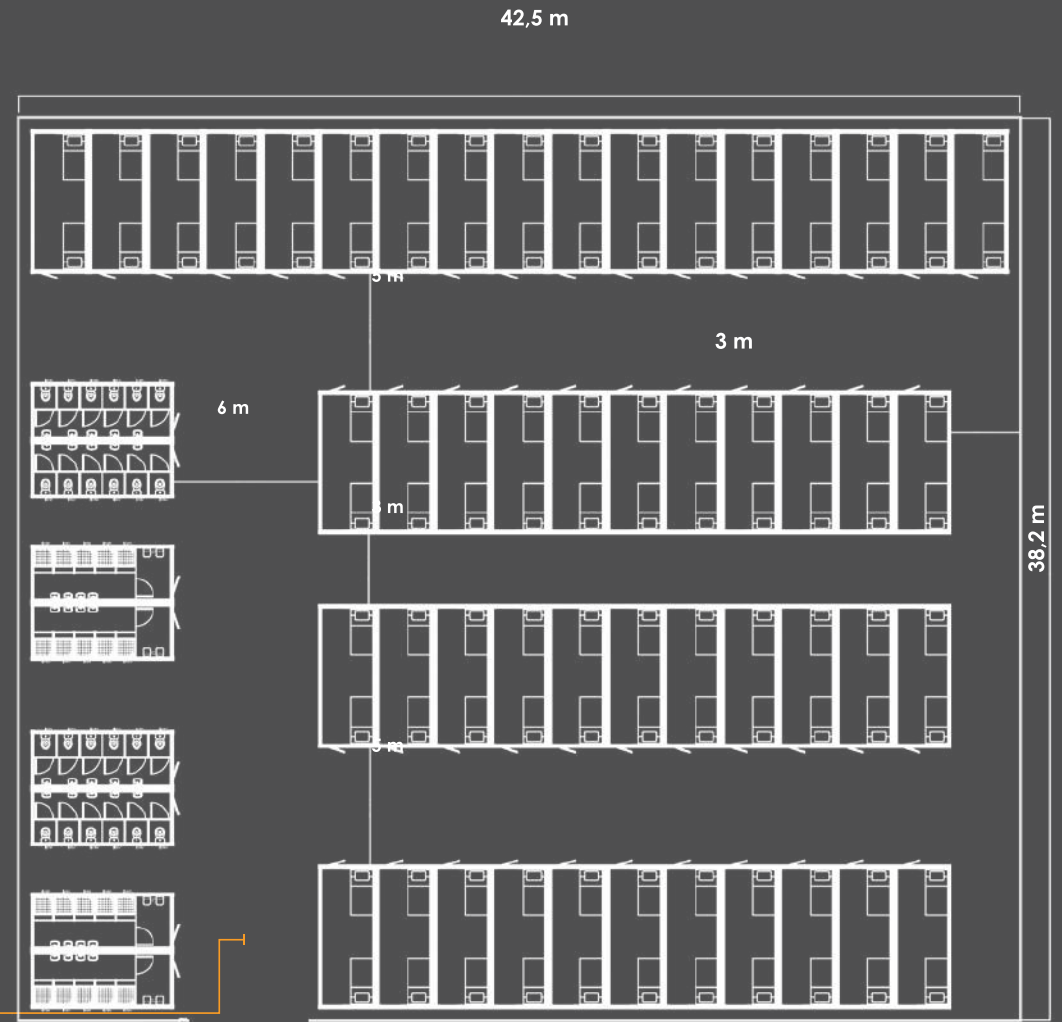

NORMAL CAPACITY (1 CONTAINER = 2 PERSONS) 100 PERSONS

MODULAR CONTAINER:	50 MODULES	} TOTAL 58 MODULES
SHOWER CONTAINER:	4 MODULES	
WC CONTAINER:	4 MODULES	

One Storey Modular Container Camp

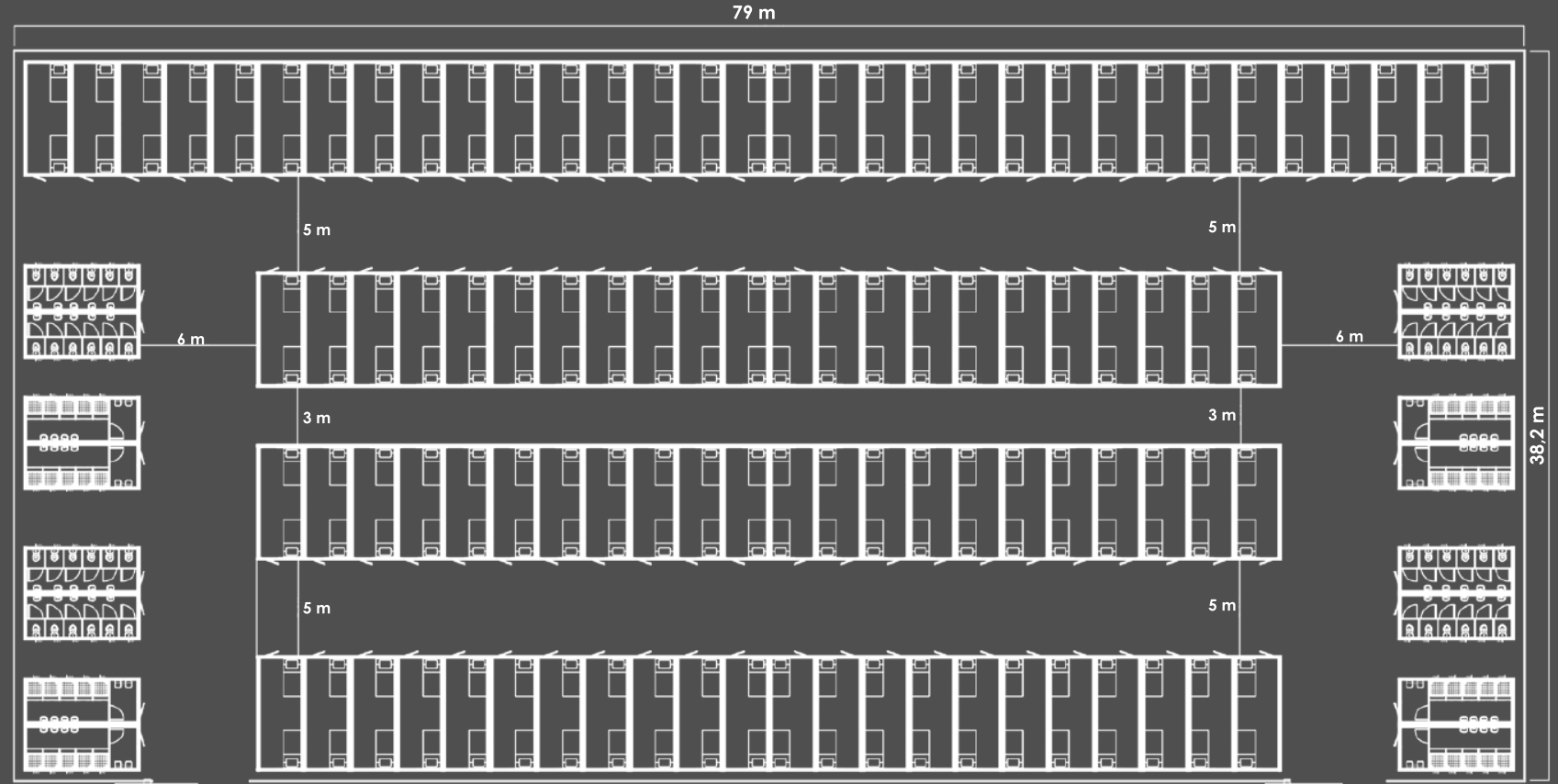

NORMAL CAPACITY (1 CONTAINER = 2 PERSONS) 196 PERSONS

MODULAR CONTAINER: 98 MODULES

SHOWER CONTAINER: 8 MODULES

WC CONTAINER: 8 MODULES

} TOTAL 114 MODULES

Two Storey Modular Container Camp

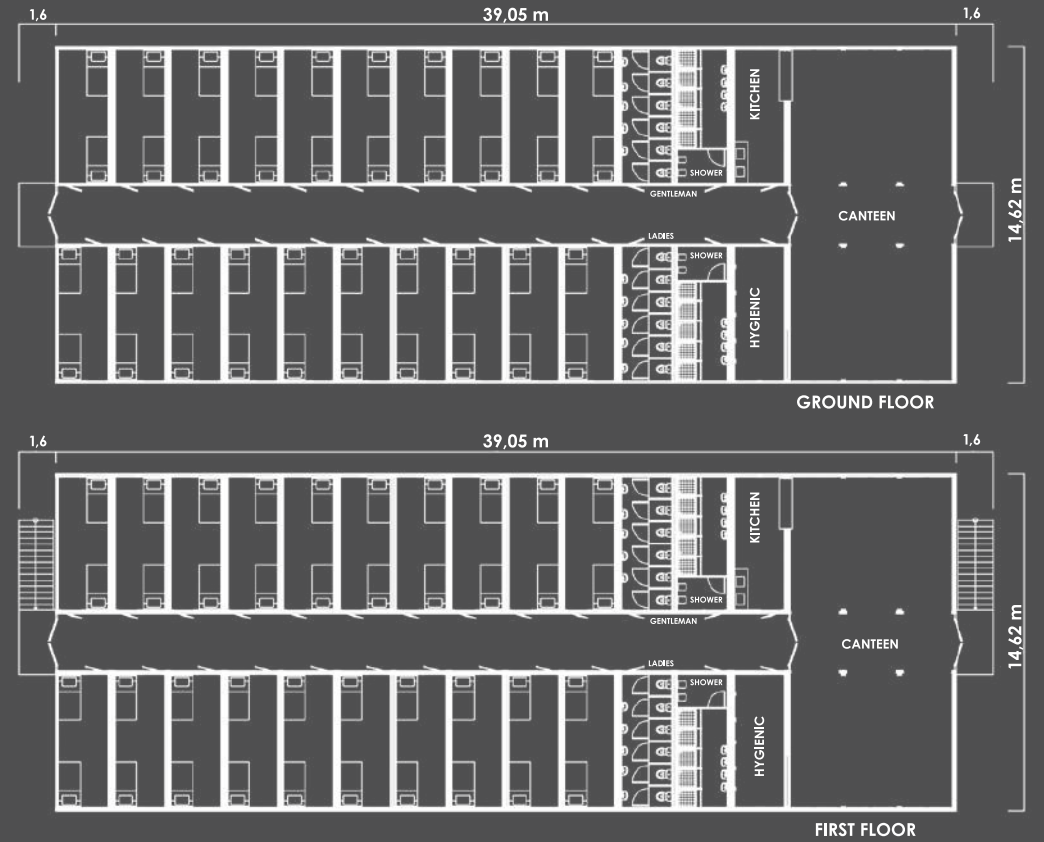

NORMAL CAPACITY (1 CONTAINER = 2 PERSONS) 80 PERSONS

- MODULAR CONTAINER: 40 MODULES
 - SHOWER CONTAINER: 4 MODULES
 - WC CONTAINER: 4 MODULES
 - HYGIENIC CONTAINER: 2 MODULES
 - KITCHEN CONTAINER: 2 MODULES
 - CANTEEN CONTAINER: 12 MODULES
- } TOTAL 64 MODULES**

Two Storey Modular Container Camp

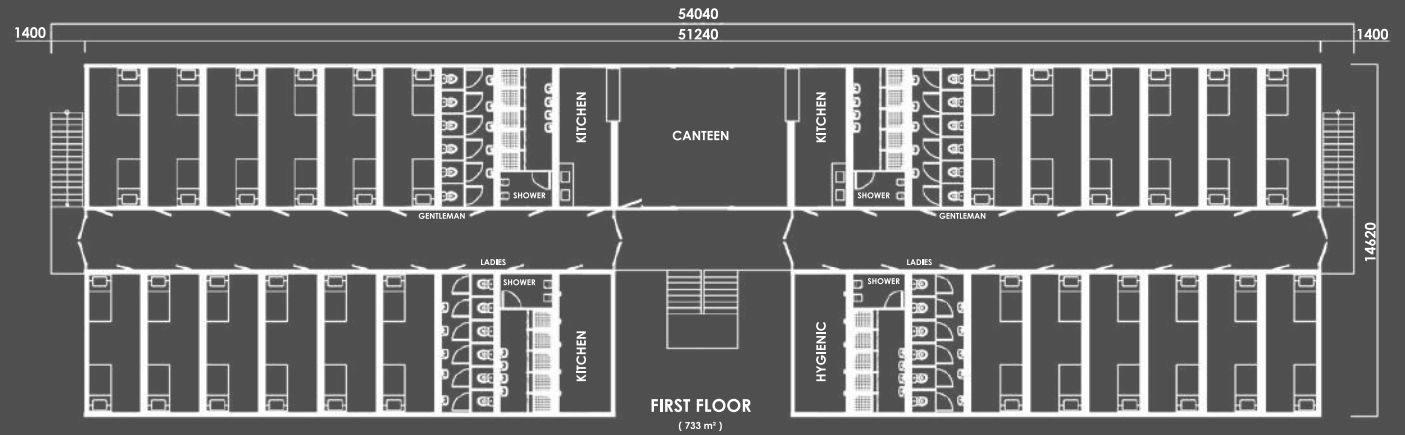

NORMAL CAPACITY (1 CONTAINER = 2 PERSONS) 192 PERSONS

MODULAR CONTAINER: 48 MODULES
 SHOWER CONTAINER: 8 MODULES
 WC CONTAINER: 8 MODULES
 HYGIENIC CONTAINER: 4 MODULES
 KITCHEN CONTAINER: 4 MODULES
 CANTEEN CONTAINER: 6 MODULES

TOTAL 78 MODULES

One Storey Modular Container Camp

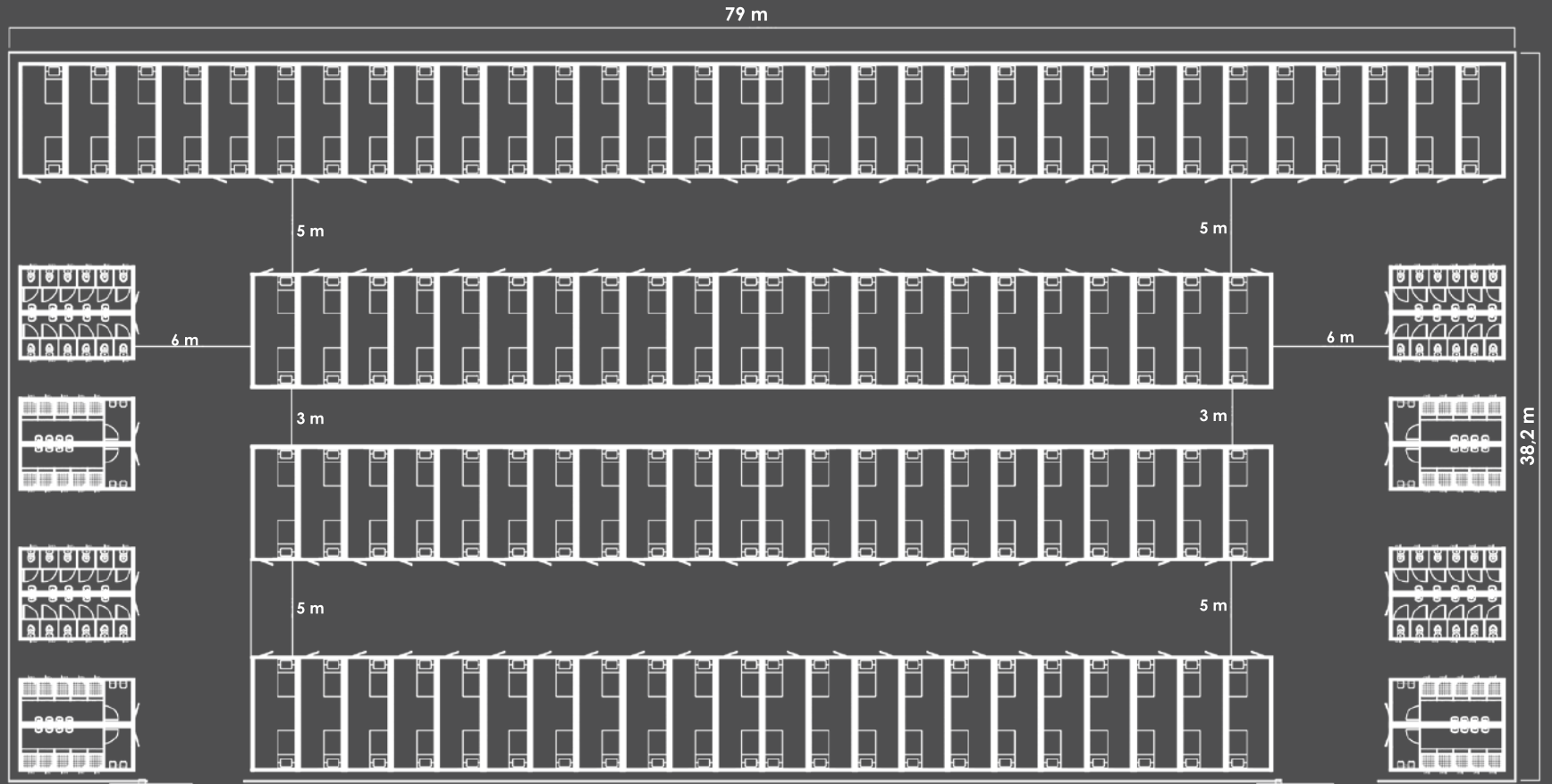

NORMAL CAPACITY (1 CONTAINER = 2 PERSONS) 196 PERSONS

MODULAR CONTAINER: 98 MODULES

SHOWER CONTAINER: 8 MODULES

WC CONTAINER: 8 MODULES

} TOTAL 114 MODULES

Modular Container Camp



Modular Container Camp



Two Storey
Modular
Container
Camp

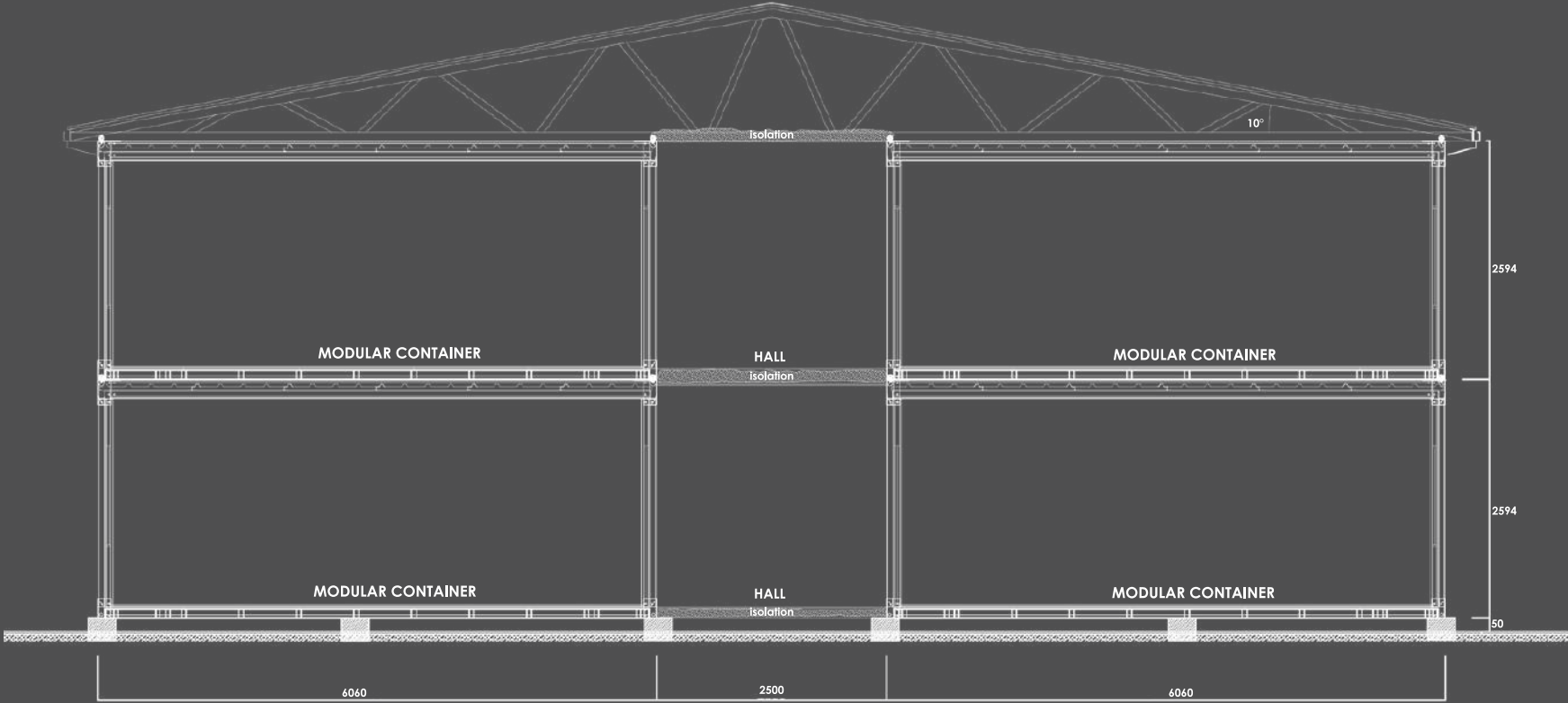

SAMPLE SECTION

Turkish Airlines - Hangar Office



Taşköprü Modular Office



Sanitary Containers

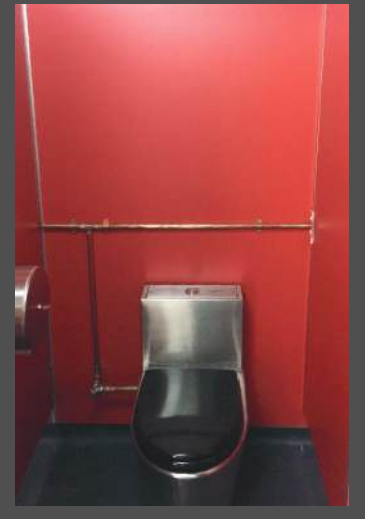

Sound Insulated Modules



GSM Cabins & Equipment Units



Germany and Netherlands Refugee Camps



Germany and Netherlands Refugee Camps



APEC

MODULAR

HEADQUARTERS

Maslak Mah. Saat Sk. No: 5
Spine Tower Kat: 17 Daire: 153
Sarıyer - İstanbul

Telefon: +90 212 280 22 00 Fax: +90 212 280 22 10

FACTORY

Taşköprü Merkez Mah. Yalova İzmit Karayolu Cad.
No: 28 / 1
Çiftlikköy - Yalova

Telefon: +90 226 333 03 03 Fax: +90 226 333 03 09

www.apecmodular.com

info@apecmodular.com



CFSEI
COLD-FORMED STEEL
ENGINEERS INSTITUTE



Steel Framing Alliance™
Steel. The Better Builder.